



IGLU DOMO 2030

Data sheet



IGLU DOMO 2030



TRANSPORTABLE
AND
SELF-SUFFICIENT
MODULARS

1 IGLU DOMO 2030

2 FEATURES

3 MATERIALS

4 ADVANTAGES

5 DESIGNS

6 EXHIBITION

7 CONTACT

FEATURES

QUICK INSTALLATION

The construction of the dome house is easy to install

POSSIBLE APPLICATIONS IGLU DOME 2030

Country house, guest house, sauna with swimming pool, shed, winter garden, hotels, recreation station, camping, resort, modernization of existing recreation stations, pensions, small boutiques and etc.

ADVANTAGES

The main advantages of this design is its quick installation (does not require lifting equipment), giving strength to the structure (consists of special panels and their spherical structure) does not require approvals (as it refers to unfounded buildings), absolutely free internal provision.



**THE FUTURE OF
MODULAR AND
SELF-SUFFICIENT HOUSES**



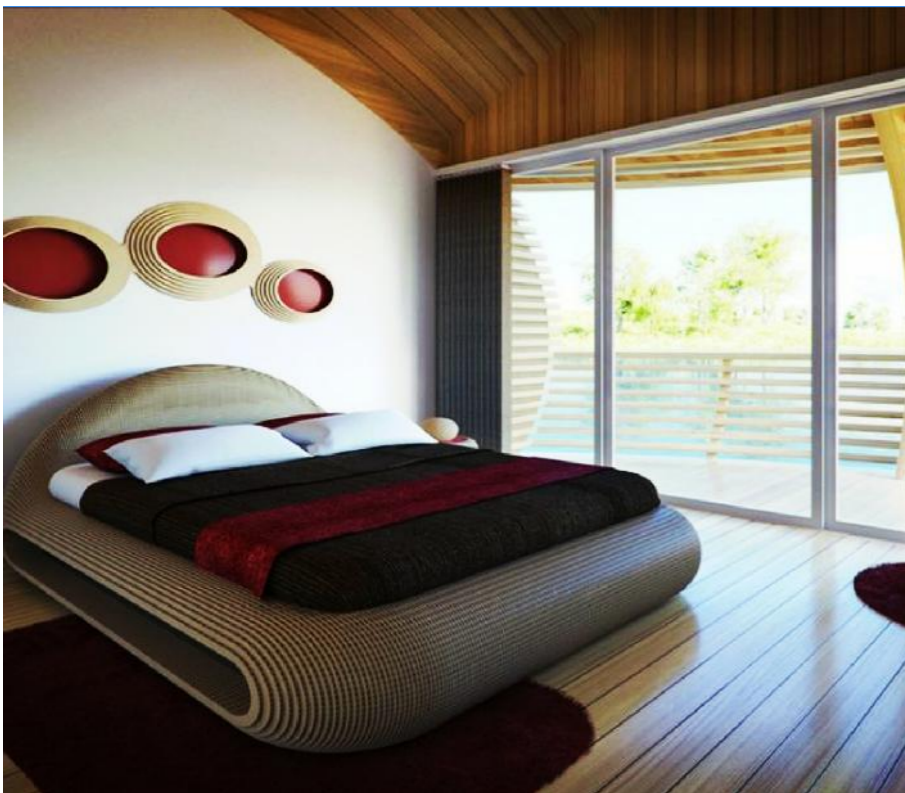

RESISTANCE AND DURABILITY

Great savings due to the insulation provided by the base of the material used in the main structure of the house.

***The most stable form in terms of structure.**

Its structure is simple and stable domeshaped, the IGLU DOMO 2030 house is extremely light and our material has the characteristic that it does not change semi-permanently unless it is affected by adverse conditions. Resilient that makes it ideal for any catastrophe.

***Tailor-made models**

Different designs can be built with different diameters, facilitating also their expansion through the coupling of modules This is a perfect way to build energy-efficient dwellings, in addition to its attractive design.

- **STABLE, ROBUST AND SAFE WALLS WITH MINIMAL HEAT LOSS.**

It is the same system used in the manufacture of cold stores, refrigerated trucks, airplanes or yachts.

- **EXTERIOR WALLS. MAXIMUM INSULATION.**

The walls are made with a high density expanded polystyrene panel system for our company. The thickness of the walls is 175mm of which 160mm are made of high density expanded polystyrene and 15mm in layers of sealant, water proofing and resins.





- **THE GENERAL CONTROL AND PROTECTION PANEL CONSISTS OF:**

A general cut-off magnetothermal switch of 40 A. This switch is independent of the power control switch (ICP), and cannot be replaced by it. A 40 A 30mA differential switch ensures protection against indirect contacts of all circuits. Three separate basic circuits are provided and shall each be protected by a manually operated omnipolar automatic cut off switch. C1.10 A. Magnetic Thermal Switch to power the lighting points. C2.16 A. Magnetic thermal switch for electrical outlets and refrigerators. C3. Magnetic thermal switch 16 A. for sockets in kitchen and bathroom.

All internal circuits are formed by independent lines. Cable type ES07Z1-K(AS)

The connection to the control panel is made by a unipolar copper cable with a nominal voltage of 0,6/1kv. non-fire propagators with smoke emission and reduced opacity of section 2 X 6 +6TT *Exterior lighting with exterior application, IP 65.



RINSES FLAWLESSLY

Despite their small size, our atomized water droplets are mighty. They move 3X faster than droplets from a standard shower, ensuring they effectively rinse shampoo out of even the thickest of hair.

SAVES WATER AND \$

Nebia showers save between 45-65% of water compared to standard showers, setting a new standard for water savings in the home and lowering your water bill.

FEELS AMAZING

Nebia's proprietary H₂Micro™ technology atomizes water into millions of micro droplets, making less water feel like so much more. The experience is unlike any other, blending the best of a steam room and a traditional shower.

OPTIONS FOR TOTAL SUSTAINABILITY



***VENTILATION BASED ON FILTERING AND AIR CHANGE WITH AIR CONDITIONING.**

THE ECOVENT VERSO

opens up completely new possibilities for the economical ventilation of single rooms.

The EcoVent Verso is particularly useful if there is limited space available due to its compact dimensions, whether it is used in new construction or renovation, for single-family houses or apartment buildings.

COMPACT DIMENSIONS FOR EXTERNAL WALL INSTALLATION WITH MINIMUM SPACE REQUIREMENTS.

ECONOMICAL EC FANS FOR MAXIMUM ENERGY EFFICIENCY.

HEAT RECOVERY EFFICIENCY OF UP TO 88 % (ACC ORDING TO LATEST DIBT TEST PROCEDURE)

CONVENIENT CONTROL, CAN BE CONNECTED TO EXTRACT AIR SYSTEMS FOR COMBINED VENTILATION.

SIMPLE COMMISSIONING BY CONNECTING THE CONTROLLER TO THE PC OR LAPTOP.

MULTIPLE AWARD-WINNING DESIGN, PERFECTLY SUITABLE FOR THE HELIOS EXTRACT AIR SOLUTIONS ULTRA SILENCE® ELS AND MINIVENT® M1.



*BIODIGESTER

Small-scale digesters transform in a local and simple way the organic remains that we produce in the home in:

Biogas: combustible gas (65% methane 35% carbondioxide). This renewable energy source can be used for cooking, in a hot water boiler or in generators for the production of electrical energy among other uses.

Organic fertilizer: the microorganisms present in the digester transform the organic residues in the matter of easy absorption by plants. Applying organic fertilizer in soils increases soil fertility and therefore improves yields in food production.

The use of small-scale digesters encourages local circular economy models based on organic waste recycling, renewable energy production and sustainable agriculture. Treating organic waste in a digester reduces our carbon footprint by preventing the methane gas produced in the decomposition of our organic waste from being released into the atmosphere. In addition, the application of organic fertilizer in soils regenerates the mycobacteria life of soils, favouring the re-transformation of the CO₂ of the environment into oxygen.



*PITS WITH FILTER SYSTEM

The compact septic tank with DEPURPACK filter is intended for the treatment of domestic or domestic wastewater. The process used is totally natural/biological, the equipment does not need any type of mechanical element to perform its function of degradation and purification of the organic load contained in the wastewater.

The system consists of three differentiated stages, decantation, digestion and clarification thanks to the biological filter incorporated prior to the discharge of the purified water. For the polyethylene models the filter works by anaerobic-type submerged bed, for the PRFV equipment you can choose between aerobic filter or submerged bed according to the position of the purified water outlet.

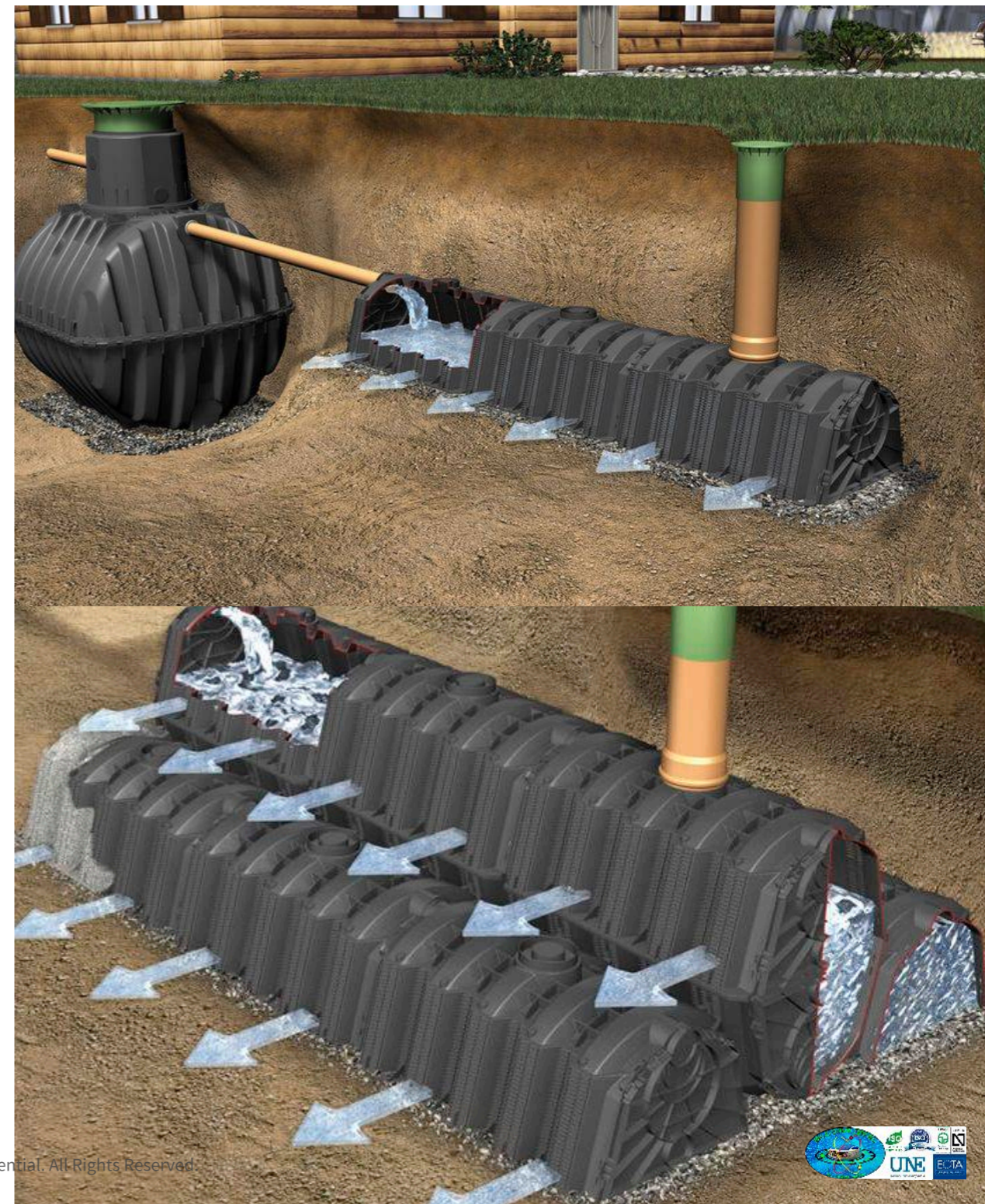

● PLUMBING

Connection to the control panel is by means of a unipolar copper cable with a nominal voltage of 0,6/1kv. non-fire propagators with smoke emission and reduced opacity of section 2 X 6 +6TT.The plumbing is constituted by a double circuit cold and hot water, connected and mounted in poly butylene tube,system PB, with external diameter of 15mm, the circuit incorporates a general tap and a tap for the emptying of the pipes.

At the end of the installation a mechanical resistance and sealing testis carried out, the maximum working pressure is expected to be 10 bar. , test pressure 3.0 Kg/cm2 . The drains are made with 32 mm PVC pipe. of section,all this sifted and prepared for the final connection of the waste water once installed in its plot. The toilet drain is 90mm..

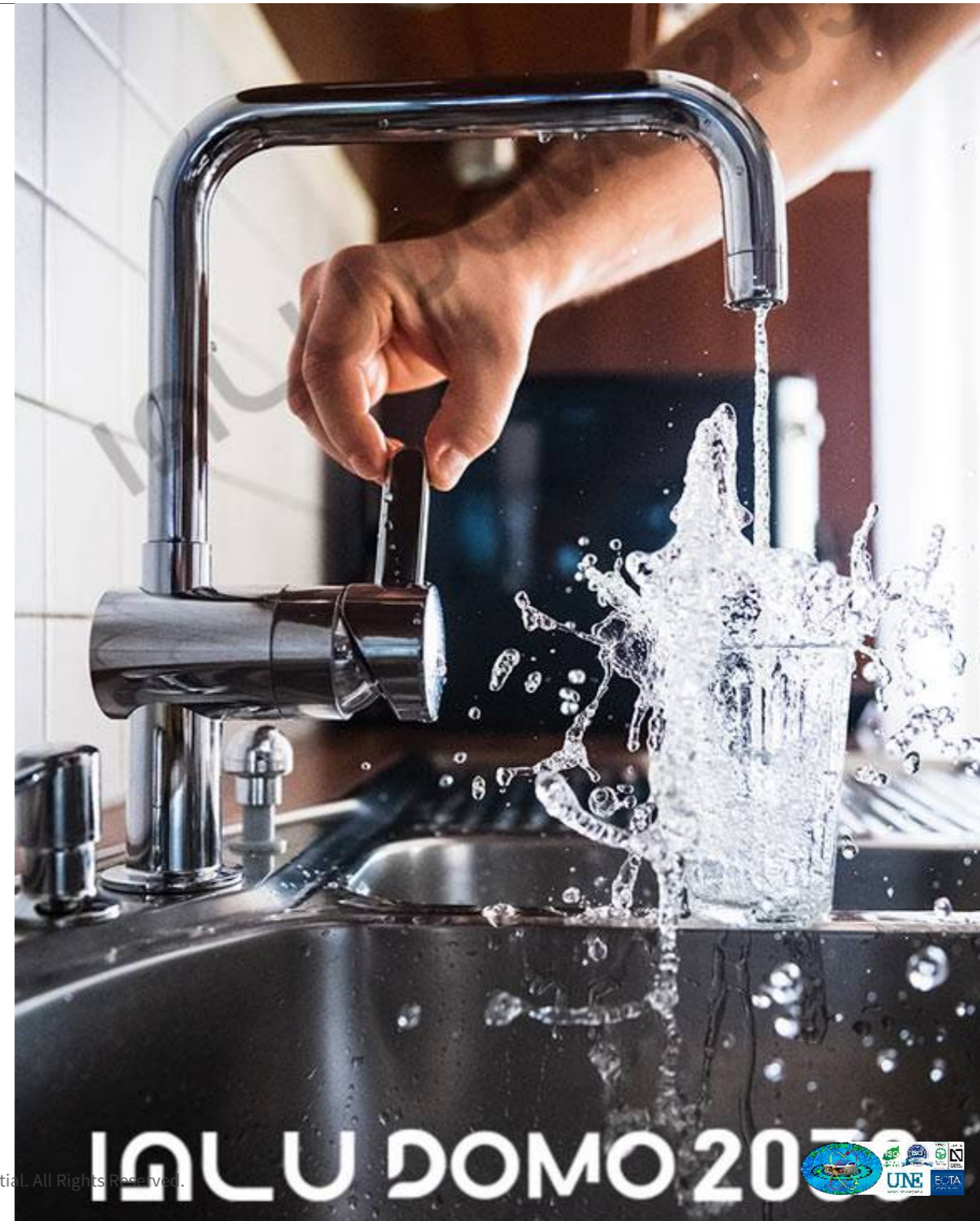

IGLUDOMO2030

MAIN MATERIALS



THERMAL INSULTION



What is GAINA Thermal Insulation?

GAINA is a liquid ceramic insulation or coating that reflects infrared rays and provides excellent qualities such as thermal insulation, water proofing, anticondensation and fire resistant once applied. As simple to apply as if it were a painting and eco-friendly.

GAINA can reduce heating and air conditioning costs by 30 to 50%.

Features of GAINA:

Excellent thermal insulation (for cold and heat), reflects infrared rays.

High water proofing and anticondensation capacity.

Fire resistant, does not spread fire, non combustible once applied and dry.

High adhesion on any type of surface, flexible, non cracked and shock resistant. Properties like acoustic insulation (lowered from 6 to 10 dB).

It eliminates bacteria, fungi, molds and odors due to its photo catalytic capacity. It accelerates the production of negative IONS, beneficial for health.

It accelerates the beneficial effects of photo catalysis. Its properties are maintained for more than 15-20 years outdoors and many more indoors.



aplicaTec Renovación

MORTERO DE RENOVACIÓN
DE FACHADAS

info+

- Adhesivo placas de poliestileno
- ETICS
- Renovación de fachadas

PRESENTACIÓN

aplicaTec Renovación se presenta en sacos de papel de 25 Kg, con lámina de plástico antihumedad, en palets retráctiles de 1.600 Kg (64 sacos).

CARACTERÍSTICAS TÉCNICAS

Agua de amasado	28% de agua (±3)
Densidad aparente del producto:	
En polvo	1,10 (±0,1) Kg/l
En pasta	1,50 (±0,1) Kg/l
Endurecido	1,45 (±0,1) Kg/l
Consumo	8 (±) 1 Kg/m ²
Reacción al fuego	Euroclase A1

RG-116

ISOLXTREM[®] SYSTEM

MALLA ISOLXTREM

Malla de fibra de vidrio indicada para el refuerzo de morteros en Sistema de Aislamiento Térmico Exterior (SATE)



Ancho	100 cm ± 1%
Longitud	50 m ± 2%
Peso	160 g/m ²
Luz malla	3,5 x 3,8 mm
Espesor	± 0,52 mm
Tejido	Half-leno
Densidad lineal	Urdimbre: 25 x 2 tex Trama: 20,5 tex
Resistencia a la tensión	Urdimbre: ≥ 2200 N/ 5 cm Trama: ≥ 2200 N/ 5 cm
Resistencia a la tensión	Urdimbre: ≥ 1400 N/ 5 cm Trama: ≥ 1400 N/ 5 cm
<small>Elongación de 28 días en una disolución al 5% de Hidróxido de Sodio</small>	
Elongación	Urdimbre: 3,8% Trama: 3,8%
<small>Elongación de 28 días en una disolución al 5% de Hidróxido de Sodio</small>	
Elongación	Urdimbre: 3,5% Trama: 3,5%

Certificado según ETAG 004



Palet de 33 unidades de 50m².

MC-DUR 1177 WV-A

Resina epoxi transparente para suelos industriales

Características del producto

- Resina bicomponente, base agua, transparente.
- Adhiere sobre superficies minerales húmedas.
- Reduce la capacidad de evaporación del agua en el hormigón fresco

Campos de aplicación

- Imprimación bajo y sobre recubrimientos polímero-cementosos y bajo selladores de resinas
- Impregnación de hormigón y pavimentos
- Curado de hormigón fresco, especialmente en zonas con ataque químico.
- Escenarios de exposición REACH: Contacto periódico con agua, inhalación permanente, aplicación

Procedimiento de aplicación

Datos técnicos de MC-DUR 1177 WV-A

Parámetro	Unidad	Valor*	Nota / Observación
Ratio de mezcla	Partes en peso	56 : 44	Resina base: endurecedor
Densidad	kg / dm ³	aprox. 1,05	
Viscosidad	mPa·s	250	a 20 °C y 50 % humedad relativa
Pot life	Minutos	aprox. 60	a 20 °C y 50 % humedad relativa
Seco al tacto (depende del clima)	Horas	aprox. 6	a 20 °C y 50 % humedad relativa
Resistencia total después de	Días	7	a 20 °C y 50 % humedad relativa
Condiciones de aplicación	°C	≥ 8 - ≤ 30	En sustrato, aire y material Humedad atmosférica relativa Temperatura por encima del punto de rocío
	%	≤ 85	
	K	3	
Consumo	Kg/m ²	aprox. 0,15 - 0,4 aprox. 0,1-0,25	Imprimación Impregnación y curado

PAINT USED : GAINA ,THE LIQUID CERAMIC THERMAL INSULATOR.



DATOS TÉCNICOS

Color	
amarillo	+

Parámetro (+23°C/50% RH) ¹⁾	Resultado
Capacidad [m] ²⁾	38
Tiempo completo de curado [tiempo] (RB024)	24
Tiempo abierto [min] ¹⁾	2-5
Tiempo para correcciones [min] ¹⁾	2-5
Agarre inicial [es]: ³⁾	
- elementos ligeros	60
- elementos pesados	120



**EPS ACTS AS A FLAME
RETARDANT AND IS
SELF-EXTINGUISHING.
(OFFICIAL CERTIFICATE)**



Ref.: FIRE BEHAVIOUR OF EPS

| 25 de febrero de 2020

Dear Sir ;

We hereby inform you that all products of EPS (expanded polystyrene) manufactured by José Manuel Valero S. L., are non-flammable fuels, what we know as "self-extinguishing". They are currently classified according to the UNE 13501-1:2007 Fire Classification Standard for Euroclases as "E" .

Previously the EPS was classified according to the Spanish standard UNE 92.110 as category M1, also non-flammable fuel, but after classifying the insulation products in Euroclases, this Spanish legislation is now obsolete.

The EPS for construction has to be Euroclase "E" obligatorily, because in case of fire, it does not contribute to the propagation in contact with other materials and can be self-extinguishing.

Regards.

JOSE ABEL ANDREU



EPS IGD2030

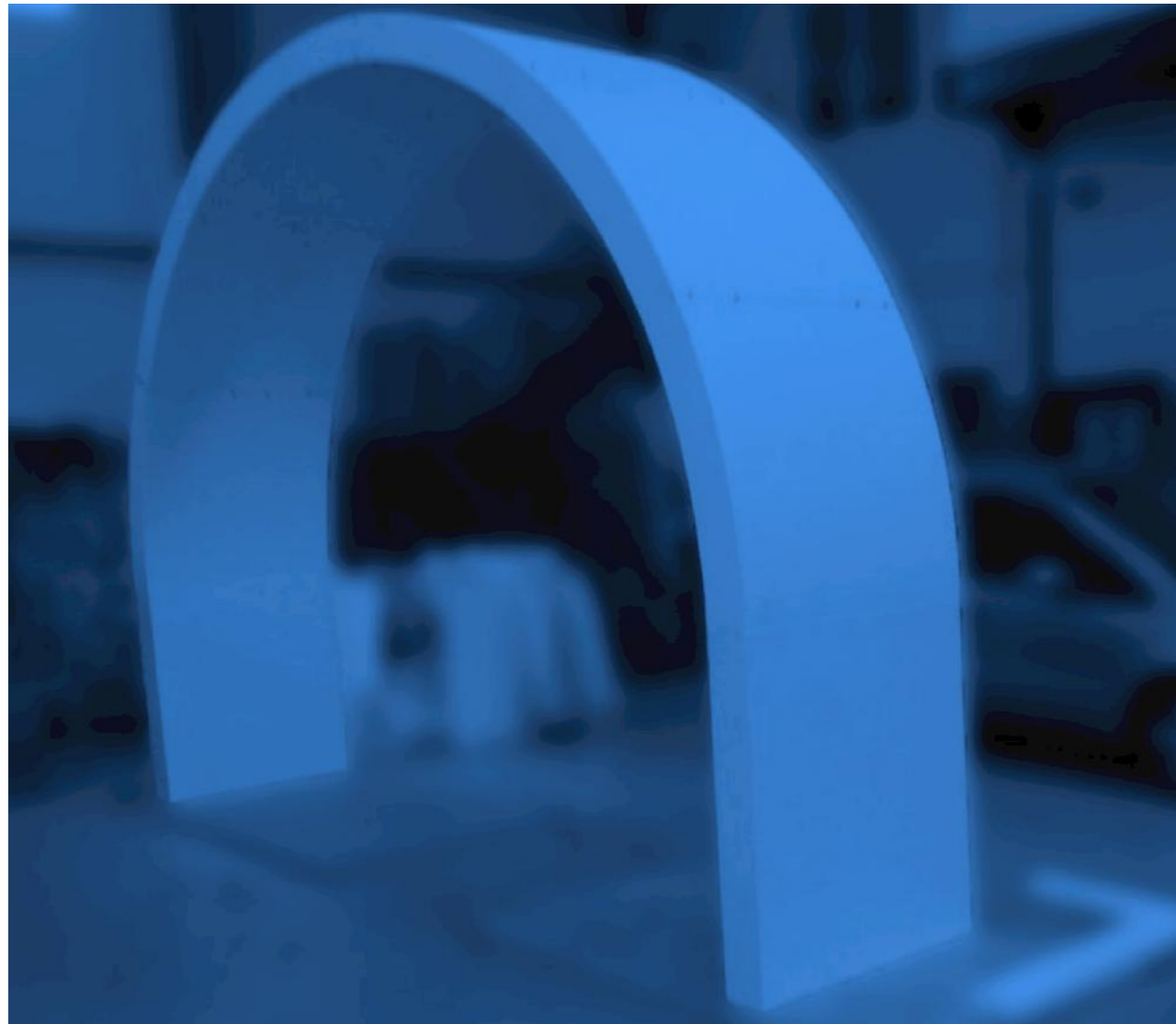

EPS IGD2030 FEATURES



Permeabilidad o Difusividad δ_v al Vapor de Agua en Función de la Densidad

δ_v (gm/MNs x 10-3)	d (kg/m ³)
7,2	10
6,2	15
5,8	20
4,8	25
4,0	30

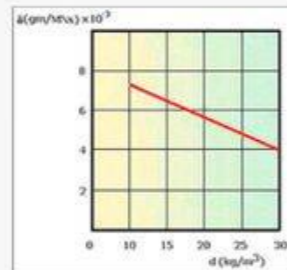

MANUFACTURING DENSITIES OF EXPANDED POLYSTYRENE

- Expanded polystyrene in plates and blocks will be manufactured at nominal apparent densities of: 10, 15, 20, 25, 30 and 40 kg/ m².
- The mean apparent density of the EPS shall be at least equal to the nominal supply value
- Individual measurement values do not differ by more than 10% from the mean value.
- In current regulations, the density of EPS blocks should be such that the cut plates have an individual density greater than or equal to 9, 13,5, 18 and 22,5. kg /m³, respectively (maximum 10% below nominal values).
- It is UNE certified for conformity with the standard density of 10 kg/m³, thermal conductivity and self-extinguishing capacity.

AMONG THE QUALITIES AND PROPERTIES OF EPS :

- High thermal and acoustic resistance thanks to its low coefficient of conductivity (e.g. discotheques, dance halls, etc.)
- Auto extinguible (Does not propagate flame): contains flame retardant.
- Negligible fuel load.
- It does not deform over time. It does not alter its thermal conductivity, it maintains its insulation capacity over time.
- It is not hygroscopic. It does not absorb or accumulate water or being submerged.
- It does not require special protection for its handling.
- It is not harmful.
- Imputrescible and insensitive to the attack of fungi and microorganisms.
- Environmentally friendly, inert, harmless, durable, 100% recyclable material, does not damage the ozone layer and is compatible with the environment.



● EPS

- Thermal insulation of building elements (exterior and interior of the building envelope).
- Insulation for radiant slabs between floors of buildings
- Filled with concrete and light for slabs.
- Sound insulation of impact noises in structures between floors.
- Absorption of vibrations produced by transport, rail, urban and related.
- Several prefabricated panels for use in residences and in the refrigeration industry.
- Mould parts to materialize the shape and complement the function of moulds or formwork.
- Complement of materials to relieve structures such as: bobedillas, lost formwork and others.
- To form decorative elements.



- Excellent thermal insulation.
- Inert, harmless, durable and environmentally compatible material.
- The recyclable product
- does not produce chloro fluorocarbons
- does not damage the ozone layer.
- Dimensionally stable. -Practically waterproof
- Resistant to aging.
- Versatile and viable.



- Lightweight, easy to size, handle, transport and place. It can be sawn, cut, perforated, brushed, sanded,elasticated, bent, nailed and screwed.
- It adheres toabsorbent and non-absorbent surfaces, such as wood,metal, concrete, masonry and various materials.
- Fixed with water-based adhesive, without toxic solvents,contributes to an environmentally compatible use.





- ECO-FRIENDLY
- OPTIMIZES ENERGY EFFICIENCY, CONTRIBUTING TO THE CONSERVATION OF NATURAL RESOURCES.
- IMPROVES THE INNER MICROCLIMATE: REDUCES AIR LEAKS AND DUST BUILD-UP.
- THE MATERIAL LIFE IS MORE THAN 50 YEARS.
- IT IS NOT SUBJECT TO DECOMPOSITION AND DESTRUCTION.
- PREVENTS THE APPEARANCE OF MOLD AND FUNGI ON ITS SURFACE.
- IT'S OF NO INTEREST TO RODENTS, BIRDS AND INSECTS.

IGLUDOMO2030

ADVANTAGES

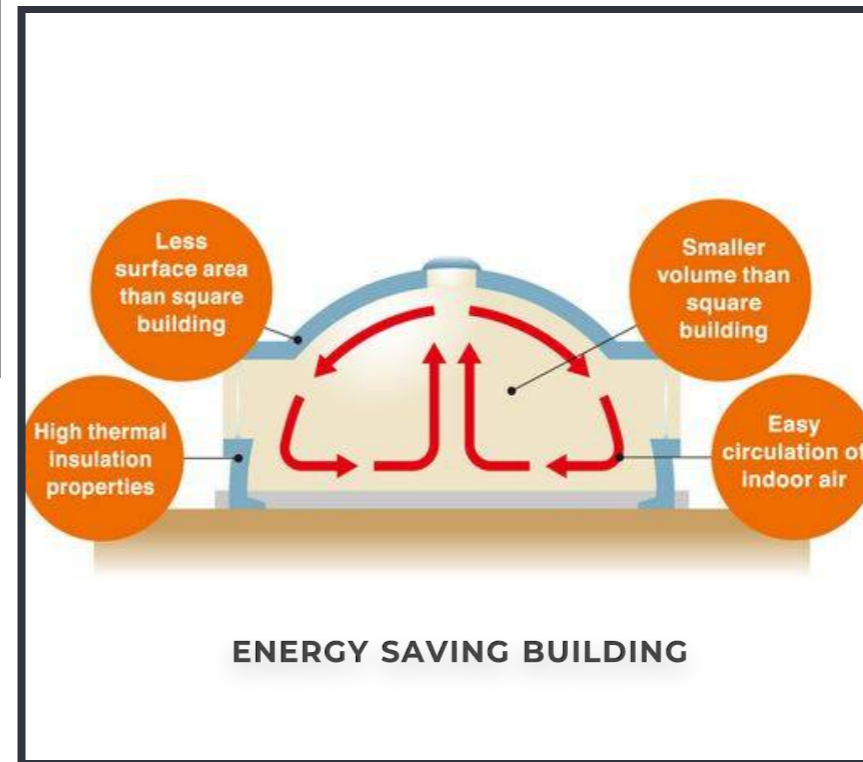
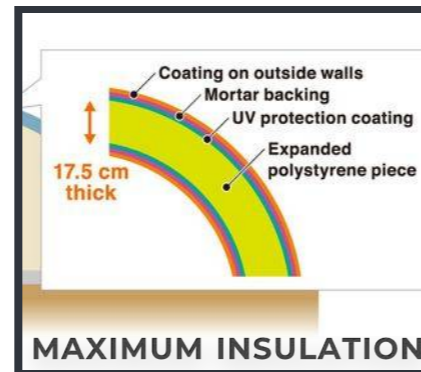
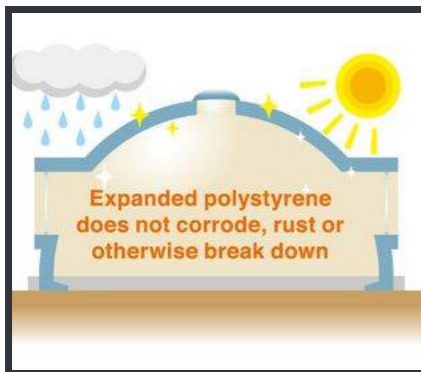
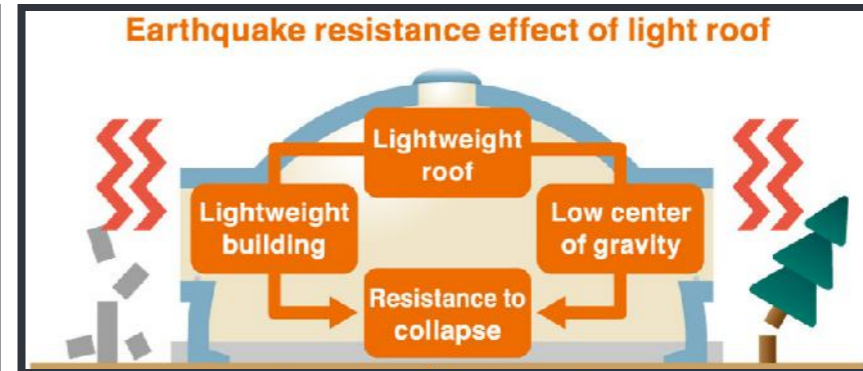
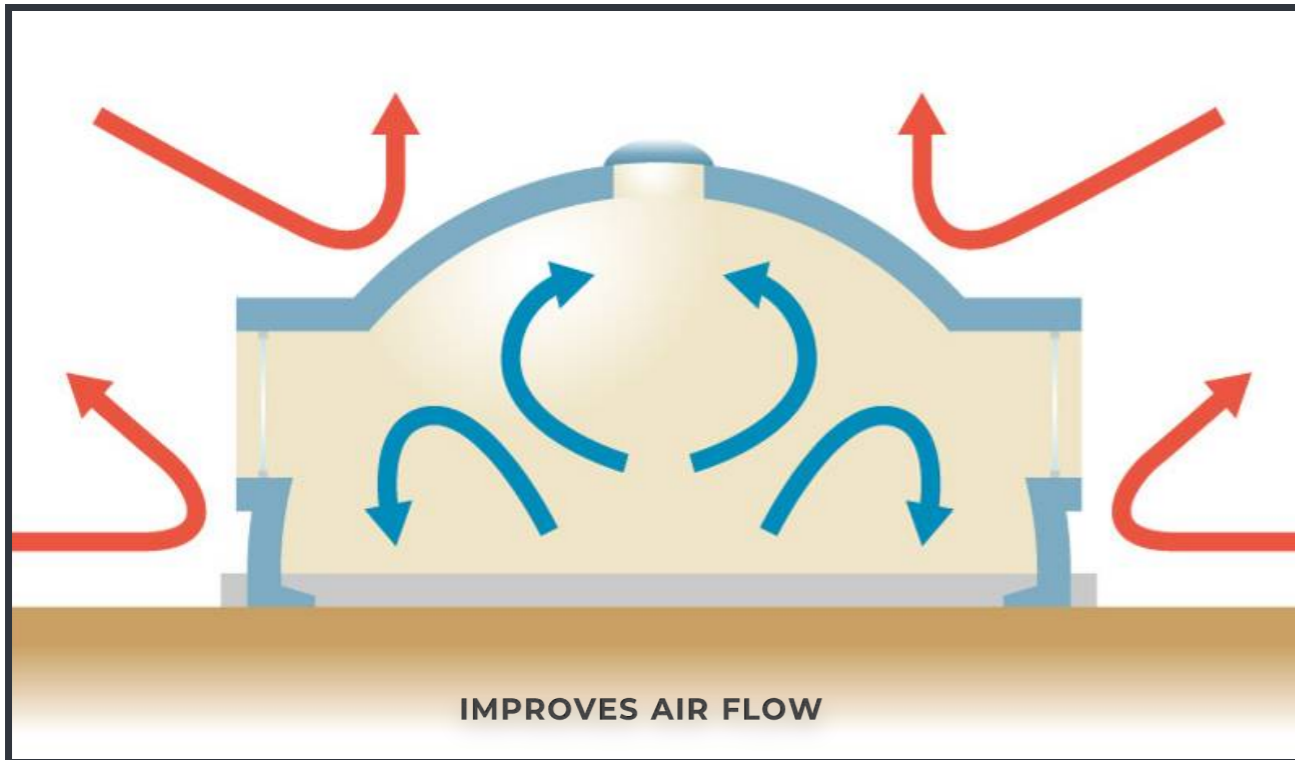

GREATLY REDUCING CO2 EMISSIONS, THE IGLU DOMO 2030 IS PROVEN TO BE ENVIRONMENTALLY FRIENDLY.

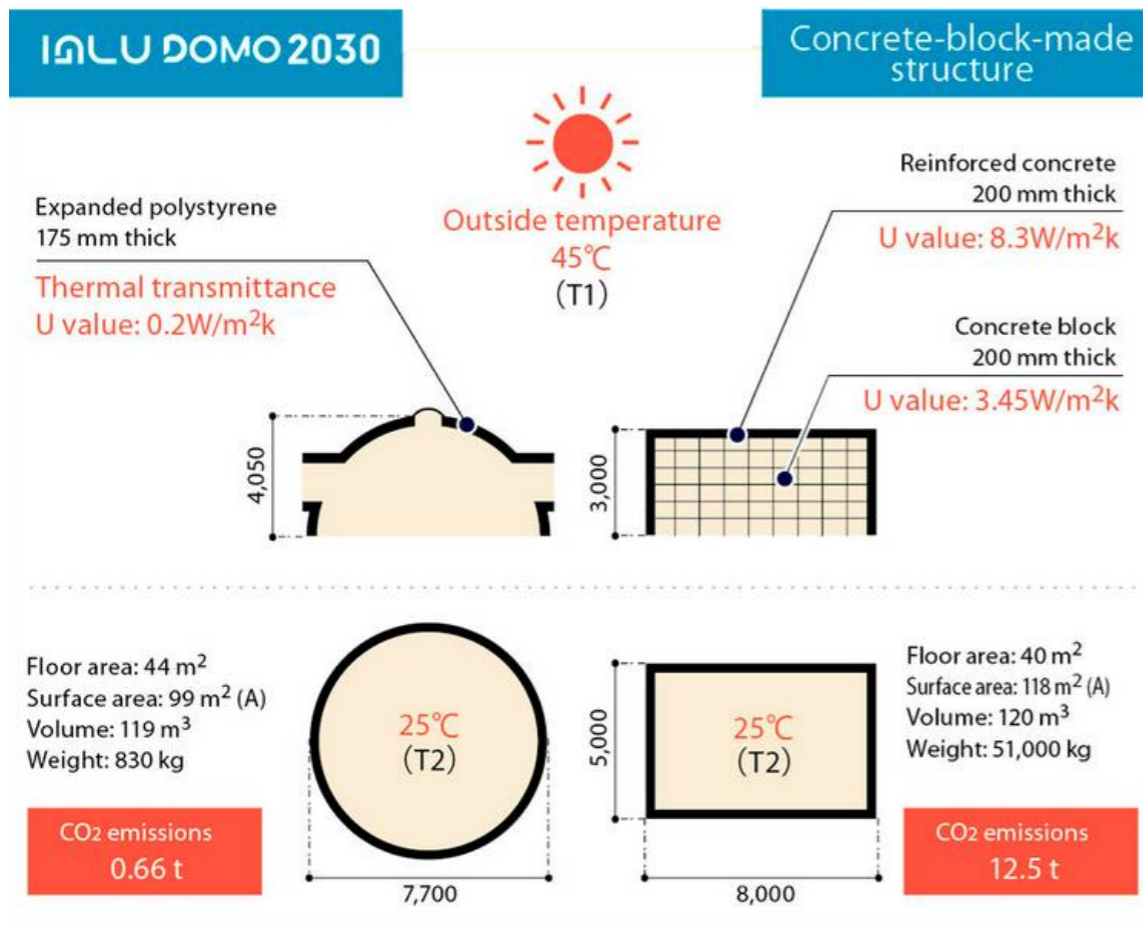

	IGLU DOMO 2030	Concrete-block-made structure
A x U thermal conductivity $\Phi = A \times U \times (T1-T2)$	30W 600W/h	705W 14,100W/h
1 day (calculated as 18 hours)	10.8KW/d	253.8KW/d
Electricity consumption per day	2.7KWh/d	63.5KWh/d
1 year (calculated as 300 days)	810KWh	19,050KWh
CO2 emissions from electricity	1.35t	31.75t

Energy savings : **18,240 kWh/y**

Annual CO2 reduction : **42.24 t**

IGLU DOMO 2030 - SUSTAINABILITY

Quick installation, in 14 days with 4 people. We have kits of panels of energy efficiency and a system of generator of “potable water”, the houses IGLU DOMO do not depend on external resources to be supplied. Quick planning and installation. Water generation and solar panels.



**WATER GENERATION AND
SOLAR PANELS.**



**QUICK PLANNING AND
INSTALLATION.**

IGLUDOMO2030

DESIGNS



THE POSSIBILITIES ARE UNLIMITED WHEN CREATING A CUSTOM DESIGN ...

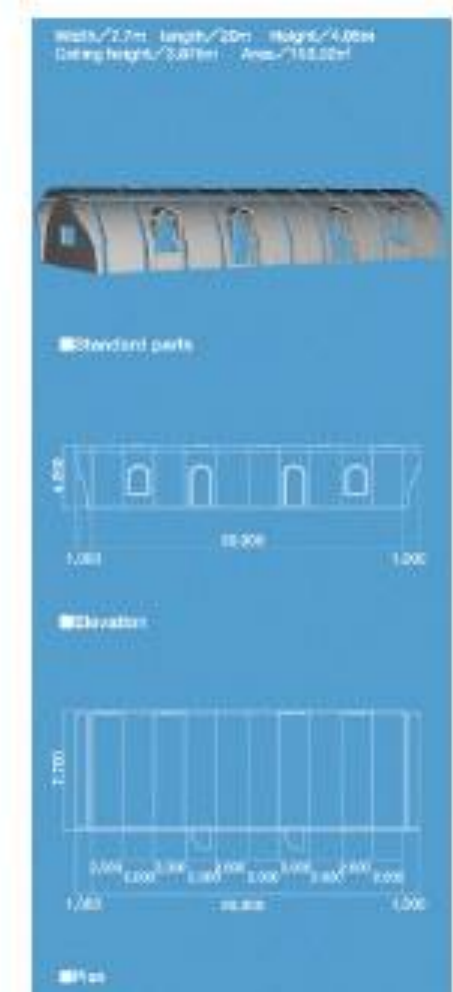
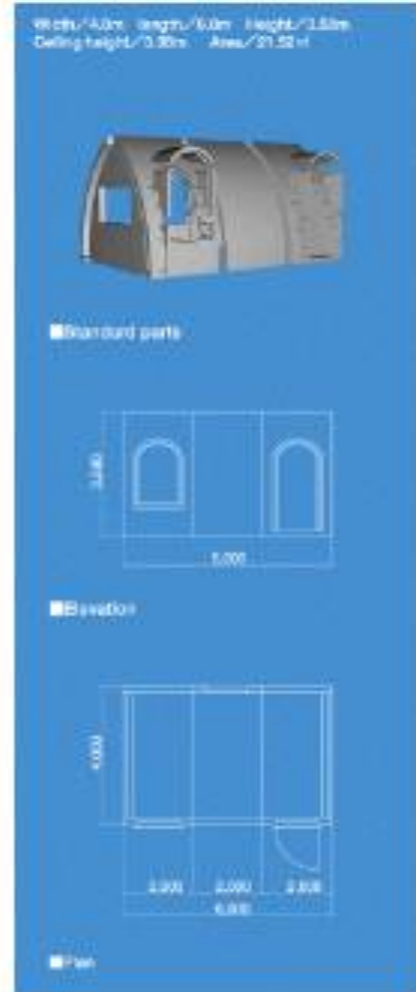
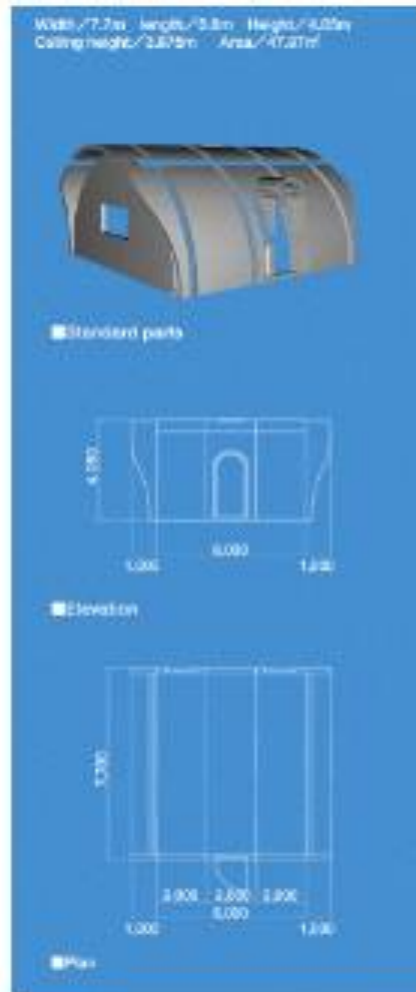
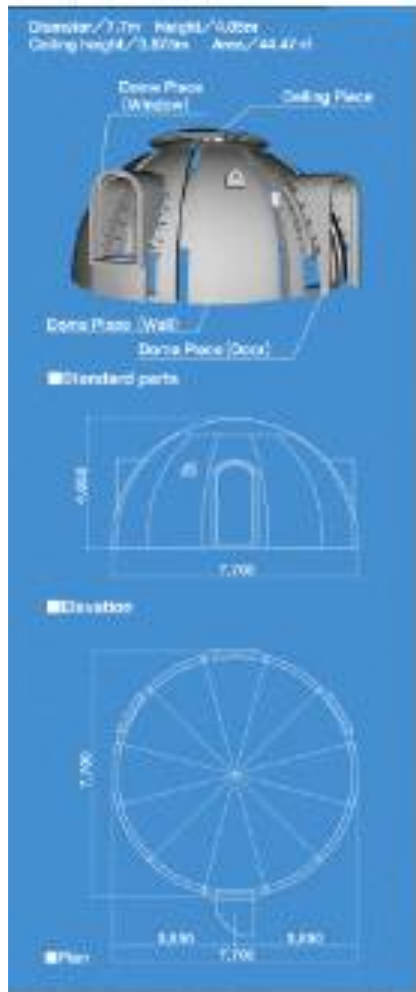

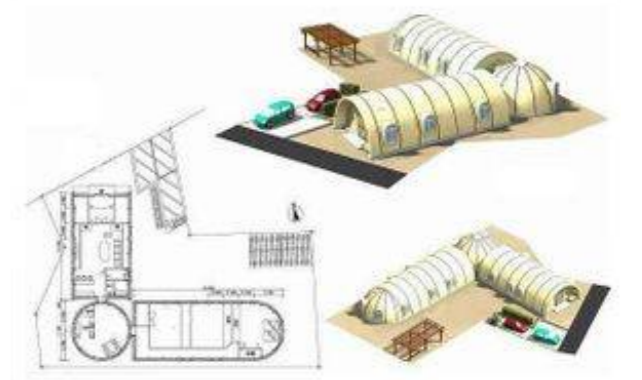
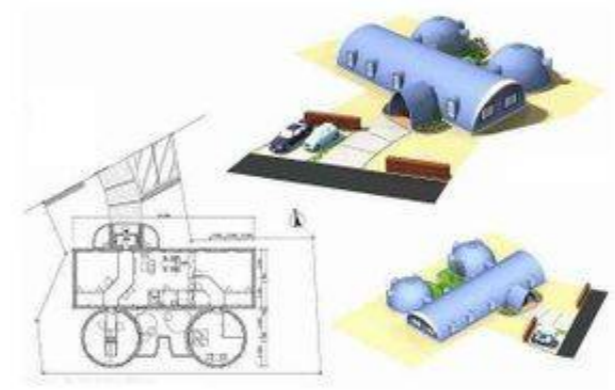
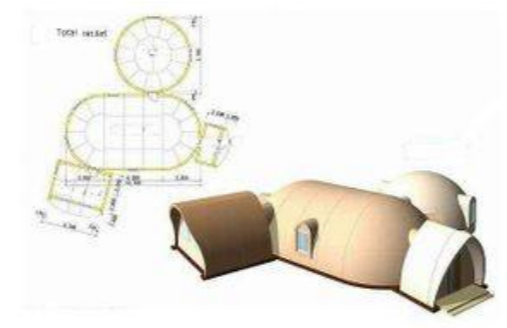
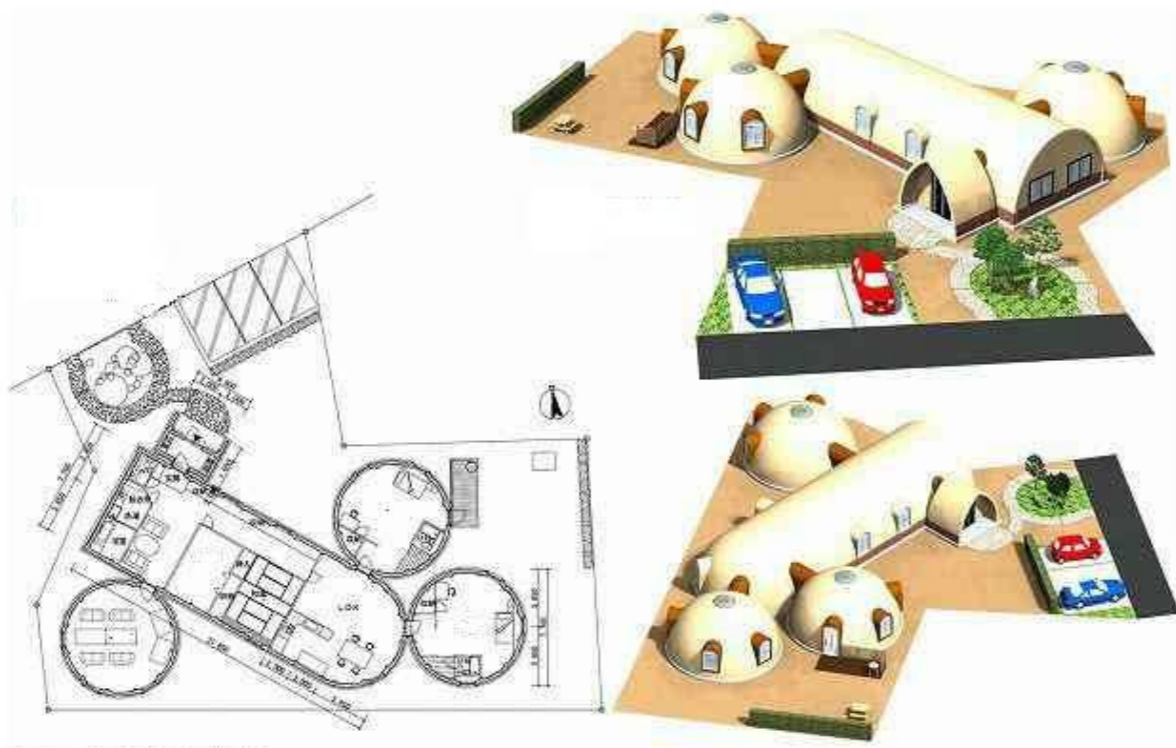

IGLUDOMO 2030

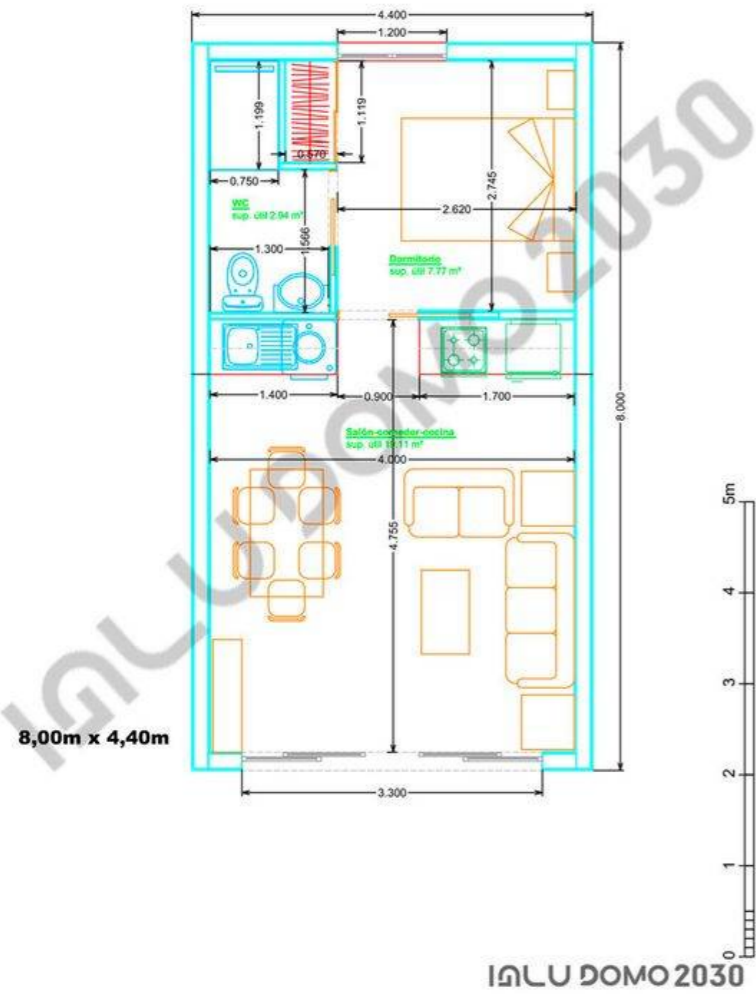

MODELO 1

IGLUDOMO 2030

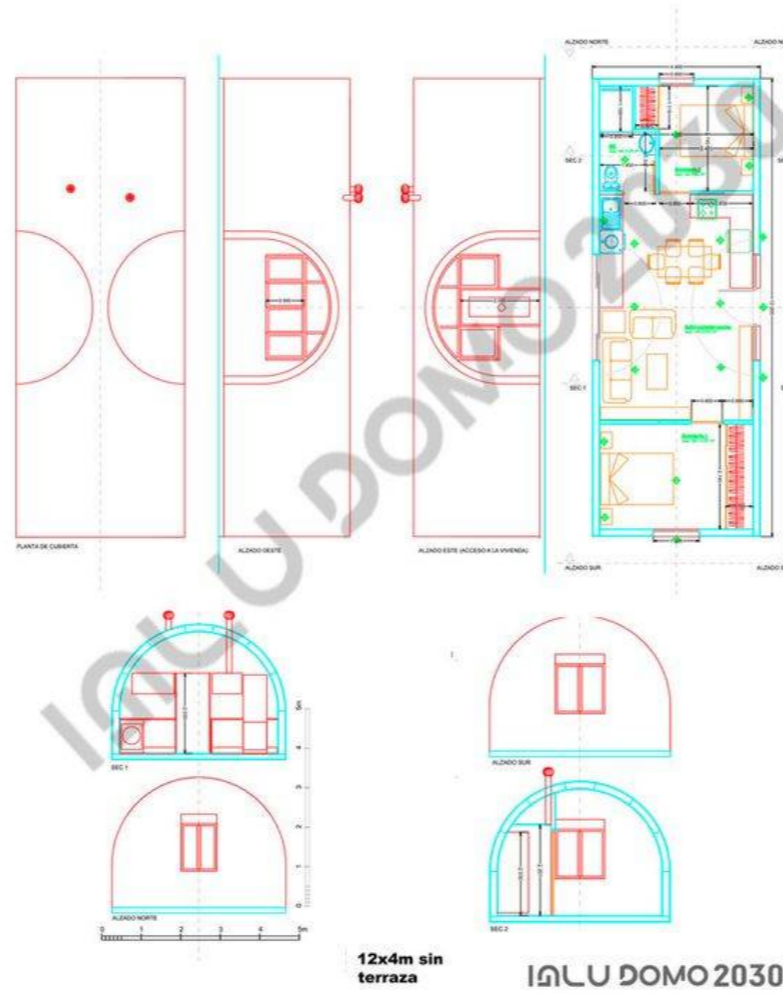

MODELO 2

IGLUDOMO 2030

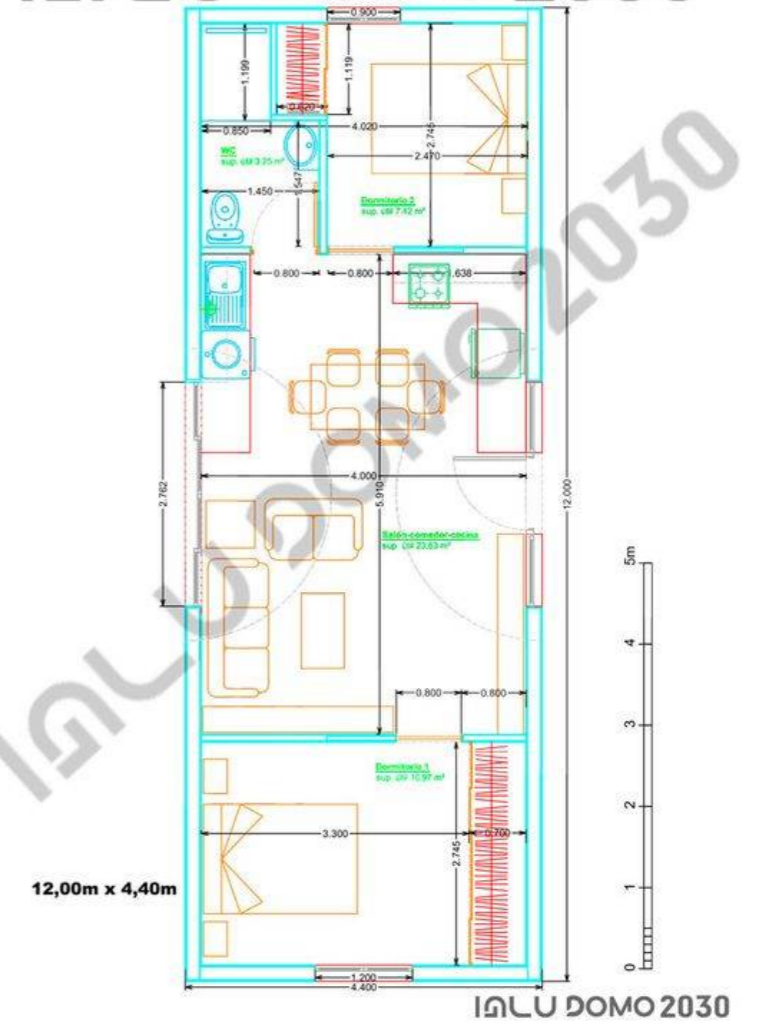

MODELO 3

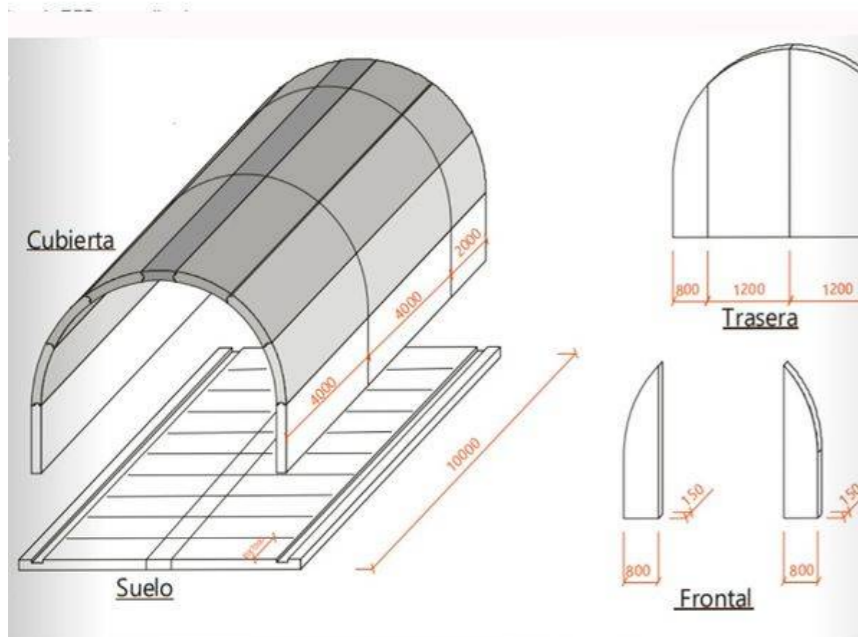
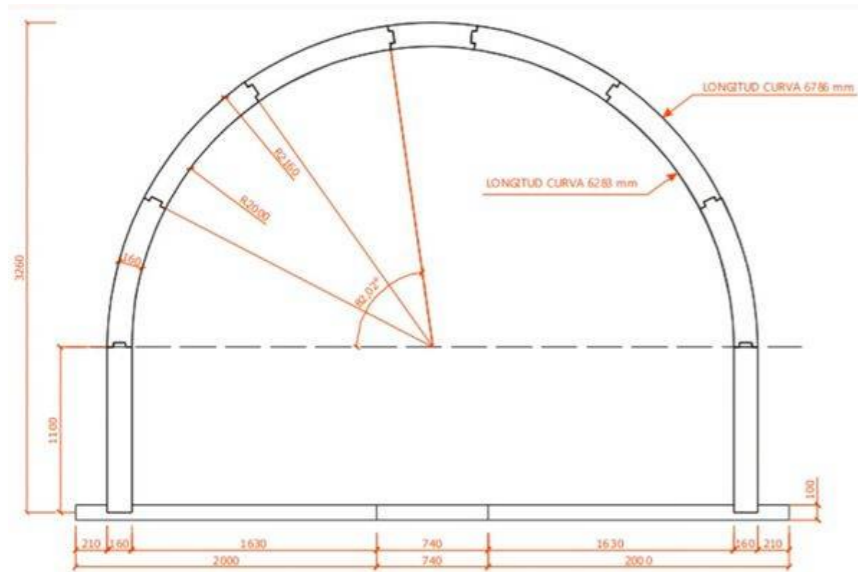

MATERIALS MODEL 32M2

● REQUIREMENTS

- Base part of the foundation.
- Resin mesh.
- Glue fiber standard glue.
- Installation of indoor/ outdoor water paint.
- Corner deck.
- 5kg per m2.

IGLU DOMO 2030 SL

HOUSE OF EXIBITION

N332 KM 193 03750 PEDREGUER
, ALICANTE



Map data ©2020 Google

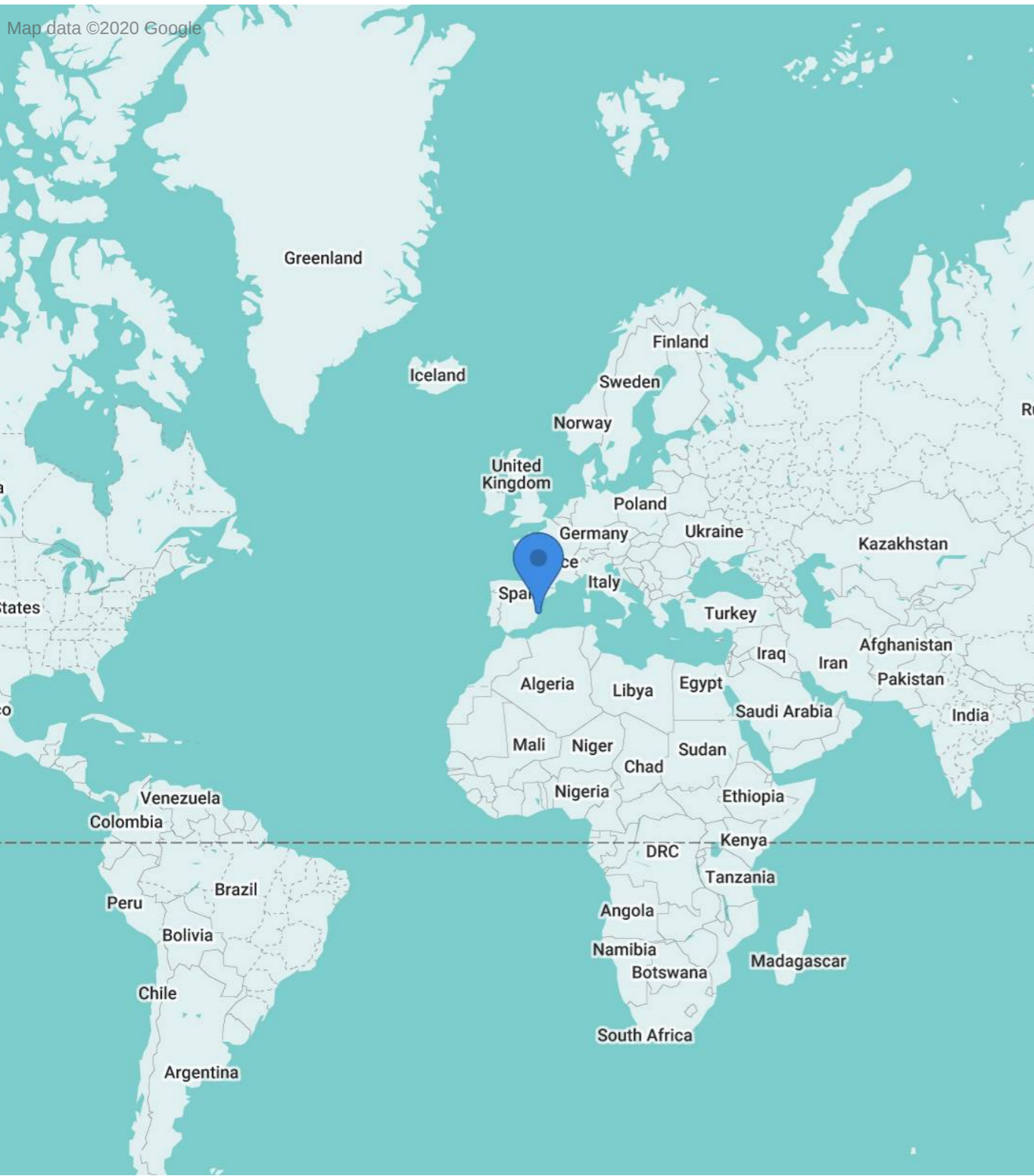

CONTACTO

NORTE DE ESPAÑA - FRANCIA - PANAMA
EXPO IGLUDOMO2030
N332 KM 193 03750 PEDREGUER , ALICANTE



+34 602 535 686



WWW.IGLUDOMO2030.COM



INFO@IGLUDOMO2030.COM



[@IGLUDOMO2030](https://www.facebook.com/IGLUDOMO2030)

SPECIAL THANKS TO ALL

This is possible thanks to the IGLU DOMO 2030 Team and our collaborator architect Hugo Grisetti.

We offer the latest technology to meet the 2030 agenda contributing to sustainability and state-of-the-art, such as: automatic closures in iris reading aperture, LED lights, shower with the latest technology on water saving, automatic taps, transparent roof, rotating house, ecological septic tank, water generator for the environment, solar panels and the solar sphere, which provides sufficient energy for the whole installation both day and night.



THE SPHERICAL SUN POWER GENERATOR



Igludomo2030 © 2020 Proprietary and Confidential. All Rights Reserved.